

# Patchwork US Flag Quilt

Finished size: 36" x 48"

## FABRIC REQUIREMENTS

Assorted Blue Blocks	25 squares 4½" x 4½" OR Star version: 16 squares 4½" x 4½" 6 squares 4" x 4" 4 squares 3½" x 3½"
Assorted Red Blocks	45 squares 4½" x 4½"
Assorted White Blocks	38 squares 4½" x 4½" PLUS 6 squares 4" x 4" for Star Version
Binding	1/6 yard
Backing	1 ½ yards

A FREE PATTERN



Use diagrams below to lay out all of the red, white, and blue 4½" x 4½" squares and sew into rows.

Press row seams in alternating directions and then sew rows together.

Vertical Layout

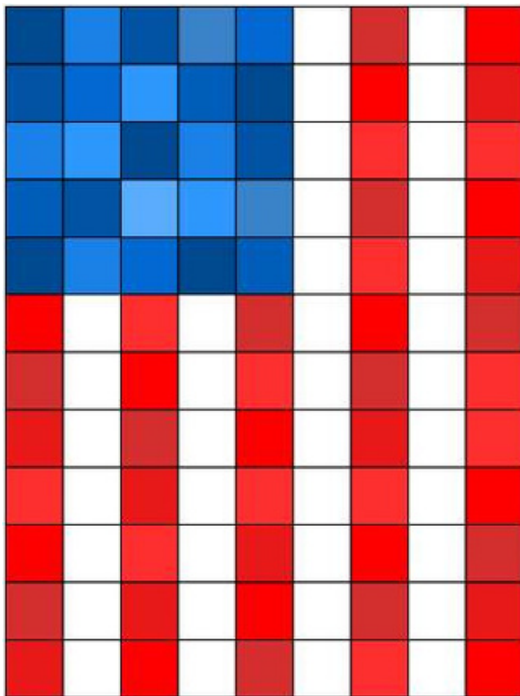

Horizontal Layout

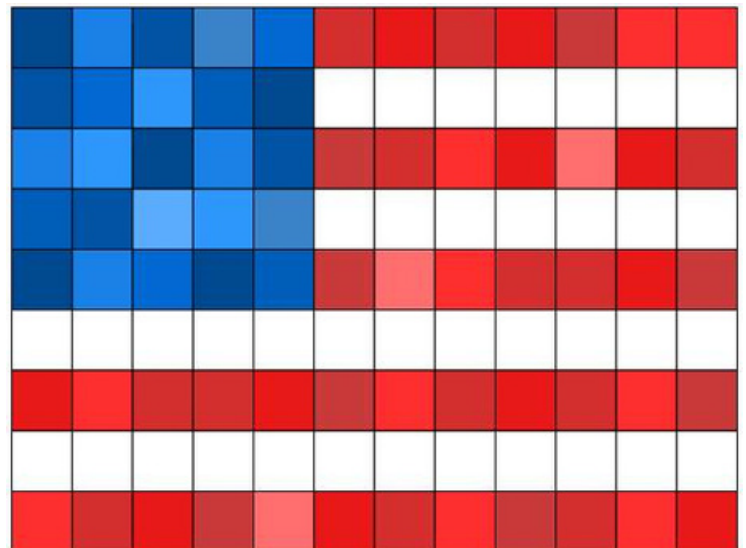

Flag Etiquette: The Blue Star Field always goes in the top left-hand corner

*Amy Smart*

DIARY of a QUILTER



# STAR VERSION

## Half Square Triangle (HST) Blocks

- Match up 6 Blue 4" x 4" squares right-sides together with 6 White 4" x 4" squares.
- Draw diagonal line on the back of white squares.
- Sew a 1/4" seam allowance on both sides of drawn line. Cut in half on the drawn line.
- Press two blocks open and square up HST blocks to 3 1/2" x 3 1/2".

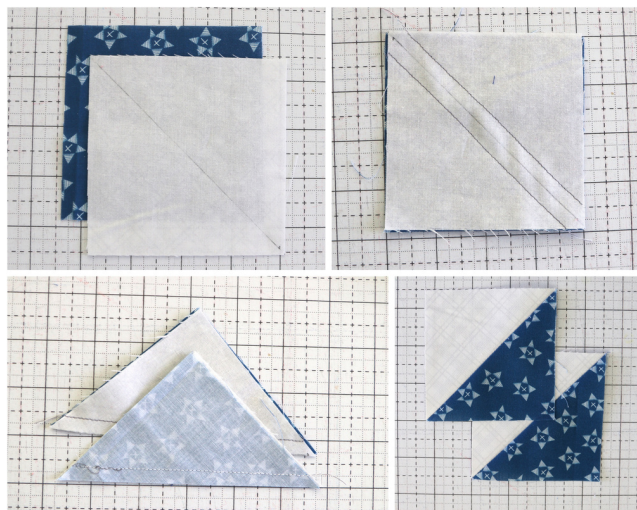

Use diagram (right) to layout 12 blue and white HST blocks with 4 blue 3 1/2" x 3 1/2" blocks in each corner.

Sew blocks into 4 rows and and sew rows together to get a 12 1/2" x 12 1/2" Star quilt block.

Sew 2 sets of 3 blue 4 1/2" x 4 1/2" blocks together in a row and sew them to top and bottom of Star Quilt Block.

Sew 2 sets of 5 blue 4 1/2" x 4 1/2" blocks together in a row and sew them to top and bottom of Star Quilt Block.



Using Diagram for lay out, Sew sections A, B, and C separately (for either Vertical or Horizontal version)

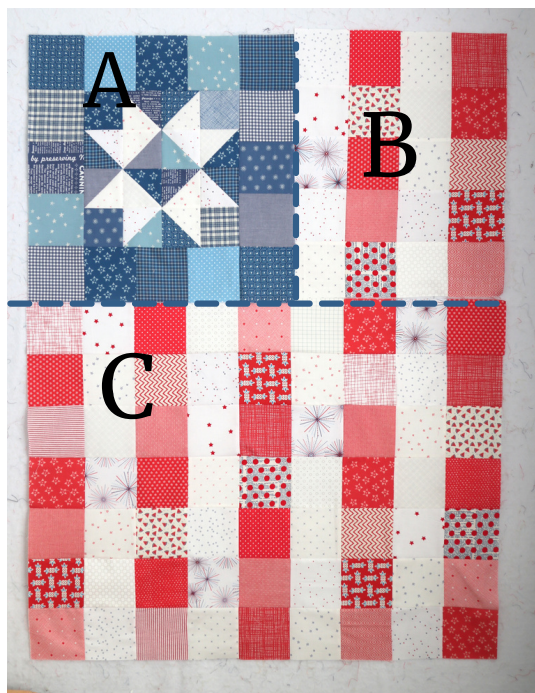

Sew section A to Section B. Then sew AB section to section C

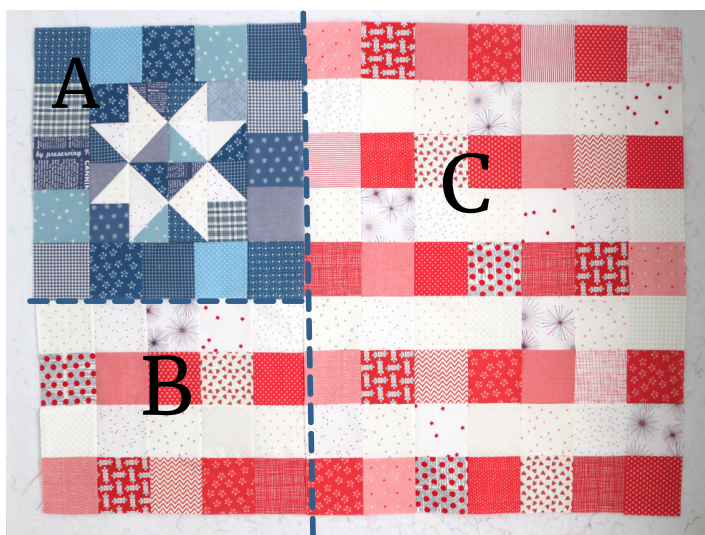

For more details + finishing tips see full post at:  
[www.DiaryofaQuilter.com/patchwork-us-flag-quilt](http://www.DiaryofaQuilter.com/patchwork-us-flag-quilt)